

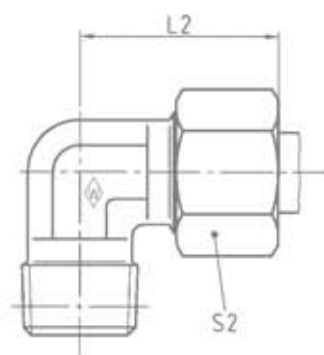

## WES ..... RK

Stud thread: BSP thread (taper)  
Einschraub-  
gewinde: Whitworth-Rohrgewinde (kegelig)  
Filetage môle: Whitworth (conique)

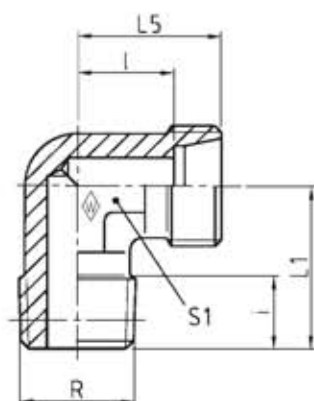

Series	bar	Tube OD	Type	Reference	kg per 100 pcs.								
Reihe	PN	Rohr-AD	Typ	Best.-Nr.	kg per 100 St.	L <sub>1</sub>	L <sub>2</sub>	L <sub>5</sub>	l	i	S <sub>1</sub>	S <sub>2</sub>	
Série	(psi)	Tube Ø ext.	Désignation	Réf.	kg par 100 p.								
						R							
LL	100 (1450)	4	R 1/8 keg	<b>WES 4 LLRK</b>	<b>037695</b>	17	21	15	11	8	9	10	
		6	R 1/8 keg	<b>WES 6 LLRK</b>	<b>037697</b>	17	21	15	9,5	8	9	12	
		8	R 1/8 keg	<b>WES 8 LLRK</b>	<b>037698</b>	20	23	17	11,5	8	12	14	
L	250 (3626)	6	R 1/8 keg	<b>WES 6 LRK</b>	<b>037699</b>	20	27	19	12	8	12	14	
		6	R 1/4 keg	<b>WES 6 L/R 1/4 K</b>	<b>037700</b>	26	29	21	14	12	12	14	
		8	R 1/4 keg	<b>WES 8 LRK</b>	<b>037701</b>	26	29	21	14	12	12	17	
		10	R 1/4 keg	<b>WES 10 LRK</b>	<b>037702</b>	27	30	22	15	12	14	19	
		10	R 3/8 keg	<b>WES 10 L/R 3/8 K</b>	<b>037703</b>	27	30	22	15	12	14	19	
		12	R 1/4 keg	<b>WES 12 L/R 1/4 K</b>	<b>037704</b>	28	32	24	17	12	17	22	
		12	R 3/8 keg	<b>WES 12 LRK</b>	<b>037705</b>	28	32	24	17	12	17	22	
		15	R 1/2 keg	<b>WES 15 LRK</b>	<b>037706</b>	8,9	34	36	28	21	14	19	27
S	160 (2321)	18	R 1/2 keg	<b>WES 18 LRK</b>	<b>037707</b>	12,0	36	40	31	23,5	14	24	32
		6	R 1/4 keg	<b>WES 6 SRK</b>	<b>037708</b>	26	31	23	16	12	12	17	
		8	R 1/4 keg	<b>WES 8 SRK</b>	<b>037709</b>	27	32	24	17	12	14	19	
		10	R 3/8 keg	<b>WES 10 SRK</b>	<b>037710</b>	28	34	25	17,5	12	17	22	
		12	R 3/8 keg	<b>WES 12 SRK</b>	<b>037711</b>	28	38	29	21,5	12	17	24	
	400 (5801)	14	R 1/2 keg	<b>WES 14 SRK</b>	<b>037712</b>	10,6	32	40	30	22	14	19	27
		16	R 1/2 keg	<b>WES 16 SRK</b>	<b>037713</b>	13,6	32	43	33	24,5	14	24	30

L<sub>2</sub> = approximate length with nut tightened  
L<sub>2</sub> = Ungefährmaß bei angezogener Überwurfmutter  
L<sub>2</sub> = longueur approximative, l'écrou étant bloqué

\* PN 630 only applies to taper port forms;  
\* PN 630 nur bei kegeligen Einschraublöchern, sonst PN 400  
\* PN 400 is applicable to parallel port forms  
\* PN 630 seulement avec taraudage conique, sinon PN 400